



# CORDLESS TOOL SYSTEMS for **PRECISION FASTENING**

**STANLEY**<sup>®</sup>  
Engineered Fastening

 Assembly  
Technologies

# Cordless Pistol Grip Tools



**B12PB** ▶  
Pistol Inline Style



**B12PP** ▶  
Push-to-Start Style

## Benefits:

- » Ergonomic and durable design
- » Compact and lightweight
- » Low spare part costs with common gearing and outputs to STANLEY Corded Tools
- » Ideal for a wide range of handheld, low-torque screw driving applications

## TECHNICAL FEATURES

- IEEE 802.11 a/b/g/n 2.4 or 5 Ghz WiFi to QB Expert or Network Node (QB0201) and 2.4 or 5 GHz to facility network
- IEEE 802.15.4, 2.4 GHz wireless communication option to Network Node (QB0301)
- Accurate transducer closed-loop control
- Precise, Low Impedance Brushless DC motor
- Visual and audible feedback for operator aids
- Controller INSIDE the tool
  - » Data storage of 500 fastening cycles and two traces
  - » 16 Jobs / 16 Tasks / 4 Steps
- Barcode Scanner and IEEE 802.15.4 Radio Options
- DeWALT 20V (18 Volt outside North America) Platform



Page 9: Battery Packs & Chargers

Model	Rated Speed	Torque		"R" Side to Center		"L" Length		Weight w/ 4Ah Battery		Weight w/o Battery		Output		
	RPM	Nm	lb ft	mm	in	mm	in	kg	lb	kg	lb	Standard	Options	
Inline	B12PB-6	1290	6	4.4	20	0.8	264	10.4	1.55	3.4	0.96	2.1	1/4" QC	1/4" or 3/8" SD
	B12PB-9	895	9	6.6	20	0.8	264	10.4	1.55	3.4	0.96	2.1	1/4" QC	1/4" or 3/8" SD
	B12PB-14	615	14	10.3	20	0.8	264	10.4	1.55	3.4	0.96	2.1	1/4" QC	1/4" or 3/8" SD
Push-to-Start	B12PP-6	1290	6	4.4	20	0.8	264	10.4	1.55	3.4	0.96	2.1	1/4" QC	1/4" or 3/8" SD
	B12PP-9	895	9	6.6	20	0.8	264	10.4	1.55	3.4	0.96	2.1	1/4" QC	1/4" or 3/8" SD
	B12PP-14	615	14	10.3	20	0.8	264	10.4	1.55	3.4	0.96	2.1	1/4" QC	1/4" or 3/8" SD

Total vibration emission value: <2.5 m/sec<sup>2</sup> (ISO 28927-2:2009); Sound pressure level at work station LpA (ref 20µPa) is < 70dB(A) (ISO 15744-2002).



# Cordless Lever Style Tools



▲ **B12LA Right Angle Lever Style**

▲ **B12LB Inline Lever Style**



## Benefits:

- » Ergonomic and durable design
- » Compact and lightweight
- » Low spare part costs with common gearing and outputs to STANLEY Corded Tools
- » Ideal for hard-to-reach, enclosed, overhead applications; interior assembly and installations; electronic assembly benches; and repair and rework stations.

## TECHNICAL FEATURES

- IEEE 802.11 a/b/g/n 2.4 or 5 Ghz WiFi to QB Expert or Network Node (QB0201) and 2.4 or 5 GHz to facility network
- IEEE 802.15.4, 2.4 GHz wireless communication option to Network Node (QB0301)
- Accurate transducer control
- Precise, Low Impedance Brushless DC motor
- Visual and audible feedback for operator aids
- Controller INSIDE the tool
  - » Data storage of 500 fastening cycles and two traces
  - » 16 Jobs / 16 Tasks / 4 Steps
- Barcode Scanner and IEEE 802.15.4 Radio Options
- DeWALT 20V (18 Volt outside North America) Platform

Page 9: Battery Packs & Chargers

Model		Rated Speed		Torque		"R" Side to Center		"H" Head Height		"L" Length w/ 4Ah Battery		Weight w/ 4Ah Battery		Weight w/o Battery		Output	
		RPM		Nm	lb ft	mm	in	mm	in	mm	in	kg	lb	kg	lb	Standard	Options
Lever Angle	B12LA13-8	838	8	5.9	13	0.5	33.2	1.3	386.1	15.2	1.65	3.65	1.04	2.3	3/8" SD	1/4" SD, 1/4" QC or Flush	
	B12LA13-11	582	11	8.1	13	0.5	33.2	1.3	386.1	15.2	1.65	3.65	1.04	2.3	3/8" SD	1/4" SD, 1/4" QC or Flush	
	B12LA13-16	401	16	11.8	13	0.5	33.2	1.3	386.1	15.2	1.65	3.65	1.04	2.3	3/8" SD	Flush	
Inline	B12LB-5	1257	5	3.7	17.8	0.7	N/A		423.5	16.7	1.61	3.55	0.98	2.15	1/4" QC	1/4" or 3/8" SD	
	B12LB-8	873	8	5.9	17.8	0.7		423.5	16.7	1.61	3.55	0.98	2.15	1/4" QC	1/4" or 3/8" SD		
	B12LB-11	602	11	8.1	17.8	0.7		423.5	16.7	1.61	3.55	0.98	2.15	1/4" QC	1/4" or 3/8" SD		

Total vibration emission value: <2.5 m/sec<sup>2</sup> (ISO 28927-2:2009); Sound pressure level at work station LpA (ref 20µPa) is < 70dB(A) (ISO 15744-2002).



**Inline Head**  
(B12LB)

**THE STANLEY ADVANTAGE:**

*Only STANLEY offers INLINE Cordless Tool in Lever Style!*

Same Gearing / Output as E Tools



**Multi-function Display Panel**

**Low Impedance Motor**

**Ergonomic Lever Start Trigger**

**Comfort Grip Handle**

**Integrated Digital Control Circuit**  
(Inside Handle)

**Micro-USB Port**  
(Back of Handle)

**Battery Pack Release Button**

**Battery Pack**



Page 9: Battery Packs & Chargers

# Cordless Lever Style Tools



**B23LA Right Angle Lever Style**

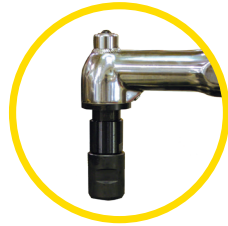

**Specialty Outputs (page 8)**

## Benefits:

- » Ergonomic and durable design
- » Compact and lightweight
- » Low spare part costs with common gearing and outputs to STANLEY Corded Tools
- » Available in specialty outputs: offset, crowfoot, tube nut, hold and drive, safe hold and drive and push-to-start

## TECHNICAL FEATURES

- IEEE 802.11 a/b/g/n 2.4 or 5 Ghz WiFi to QB Expert or Network Node (QB0201) and 2.4 or 5 GHz to facility network
- IEEE 802.15.4, 2.4 GHz wireless option communication to Network Node (QB0301)
- Accurate transducer control
- Precise Brushless, Low Impedance DC motor
- Visual and audible feedback for operator aids
- Controller INSIDE the tool
  - » Data storage of 500 fastening cycles and two traces
  - » 16 Jobs / 16 Tasks / 4 Steps
- Barcode Scanner and Zigbee Radio Options
- DeWALT 20V (18 Volt outside North America) Platform

**+** Page 9: Battery Packs & Chargers

Model	Rated Speed		Torque		"R" Side to Center		"H" Head Height		"L" Length w/ 4Ah Battery		Weight w/ 4Ah Battery		Weight w/o Battery		Output	
	RPM	Nm	lb ft	mm	in	mm	in	mm	in	kg	lb	kg	lb	Standard	Options	
<b>B23LA13-12</b>	665	12	8.8	13	0.5	33.2	1.3	537.4	21.2	2.41	5.3	1.74	3.8	3/8" SD	1/4" QC or Flush	
<b>B23LA13-17</b>	460	17	12.5	13	0.5	33.2	1.3	537.4	21.2	2.41	5.3	1.74	3.8	3/8" SD	1/4" QC or Flush	
<b>B23LA15-23</b>	370	23	17	15	0.59	39.9	1.57	552.5	21.75	2.58	5.7	1.95	4.3	3/8" SD	1/2" SD or Flush	
<b>B23LA15-35</b>	230	35	25.8	15	0.59	39.9	1.57	567.7	22.35	2.65	5.8	1.98	4.4	3/8" SD	1/2" SD or Flush	
<b>B23LA18-42</b>	180	42	31	18	0.71	39.9	1.57	563.2	22.2	2.83	6.2	2.11	4.6	3/8" SD	1/2" SD or Flush	
<b>B23LA19-52</b>	155	52	38.3	19	0.75	47.8	1.9	592.7	23.4	2.99	6.6	2.32	5.1	1/2" SD		
<b>B23LA19-70</b>	140	70	51.6	19	0.75	47.8	1.9	653.2	25.72	3.61	7.9	2.95	6.5	1/2" SD		
<b>B23LA22-95</b>	105	95	70	22	0.87	47.9	1.9	660	26.0	3.61	7.9	2.95	6.5	1/2" SD		

Total vibration emission value: <2.5 m/sec<sup>2</sup> (ISO 28927-2:2009); Sound pressure level at work station LpA (ref 20µPa) is < 70dB(A) (ISO 15744-2002).



**Angle Head Output**

*(See page 8 for Specialty Outputs)*

**Same Gearing / Output as E Tools**

**Low Impedance Motor**



**Multi-function Display Panel**

**Multifunction Button (MFB)**

**Ergonomic Lever Start Trigger**

**Comfort Grip Handle**

**Integrated Digital Control Circuit**

*(Inside Handle)*

**Micro-USB Port**

*(Back of Handle)*

**Battery Pack Release Button**

**Battery Pack**



*Page 8: Specialty Outputs;  
Page 9: Battery Packs & Chargers*

# Cordless Lever Style Tools — Full Range of Specialty Outputs

**Four output styles and many standard designs enable unique geometries that fit the application.**

- » Torque Levels From 3 to 1250 Nm and Higher
- » Hundreds of Unique Designs From Over 50 Years Experience
- » Outputs Matched to the Tool Helps Optimize Performance



## **FLUSH ANGLE**

Torque Range: 3 - 400 Nm



## **CROWFOOT**

Torque Range: 4 - 1250 Nm



## **TUBENUT**

Torque Range: 4 - 650 Nm



## **HOLD and DRIVE**

Torque Range: 11 - 380 Nm

**Hundreds of output designs enable solutions that fit your application.** STANLEY manufactures a complete range of outputs to access all types of threaded fasteners. By controlling both the design of the tool and the output, STANLEY can properly match components in the tool design to help optimize performance and long life. With over 50 years of experience in developing standard and special outputs, STANLEY has the expertise to handle the most challenging fastening requirements.



# Battery Packs & Chargers

## STANLEY 20V, 2 Ah and 4 Ah (18 Volt, 5Ah European Model) Platform

- » Estimated 2,200 fastening cycles per charge\*
- » Estimated 1,000 charge cycles throughout life\*
- » 3-LED Fuel Gauge indicator for immediate feedback on state of charge

## STANLEY Lithium Ion Battery Packs and Chargers

ITEM	DESCRIPTION
21R209700	Battery Pack, 2 Ah, North America
21R209300	Battery Pack, 4 Ah, North America
N566 441	Battery Pack, 2 Ah, Europe
E008 505	Battery Pack, 5 Ah, Europe
21R209500	Charger, North America
E008 501	Charger, Europe
E008 502	Charger, UK
E008 503	Charger 18V (Double), Europe
E008 504	Charger 18V (Double), UK



21R209700  
2 Ah Battery Pack



21R209300  
4 Ah Battery Pack



21R209500  
Charger  
North America



3-LED Fuel Gauge system for immediate feedback on state of charge



The RBRC Seal  
(on top of battery pack)

\*Dependent on application and joint rate

# QB Expert Controller



**QB4101**

*Manages up to 23 QPM Cordless Tools*

## Benefits:

- » Large Touchscreen, Color Display and Keypad
- » Quick set-up from the controller keypad, or with a PC, tablet, or smart phone
- » Alpha Toolbox, web-based software for programming, collecting data and performing diagnostics
- » Same QPM Controller platform for B-Series Cordless Tools as well as EB-Series, E-Series and EA-Series Coded Tools

## TECHNICAL FEATURES

- One Network Connection for Multiple Spindles
- Up to 23 QPM Cordless Tools
- 255 Jobs and 99 tasks with 12 steps
- Stores data for 30,000 fastening cycles
- Stores trade data for 30,000 fastening cycles
- Serial Port
- USB Port
- Embedded PLC
- 8 In/ 8 Out 24V I/O
- Embedded Modbus TCP
- Fieldbus options: Profibus, Profinet, DeviceNet, EthernetIP
- Simple or Advanced Error Proofing

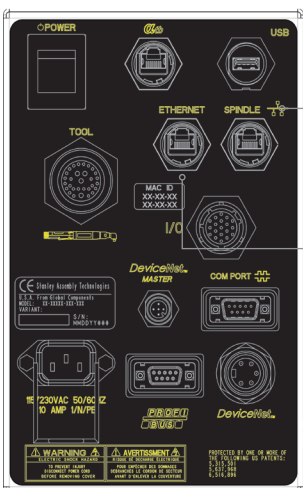

**Manages up to 24 spindles**  
(corded + cordless)

**Minimizes plant connections**  
through a single point interface to the plant network

**On board PLC**

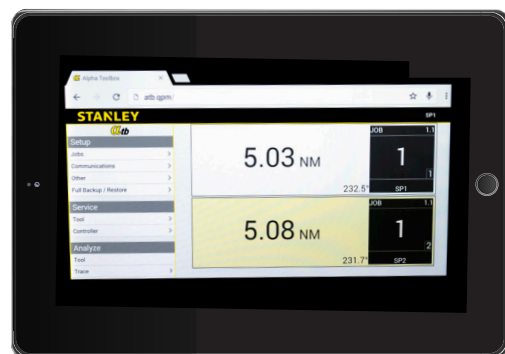

**Connect with Tablet**  
(802.11 only)

# QB Network Node

**QB0201 IEEE 802.11**  
*Manages up to 6 QPM  
 Cordless Tools*

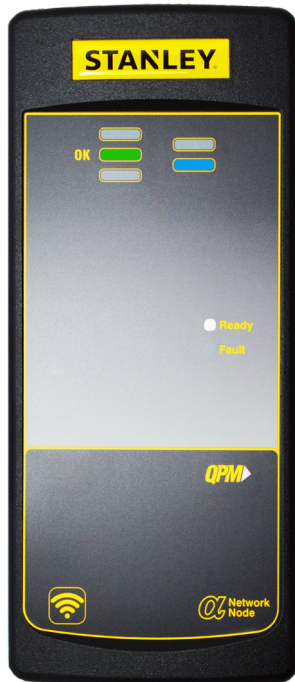
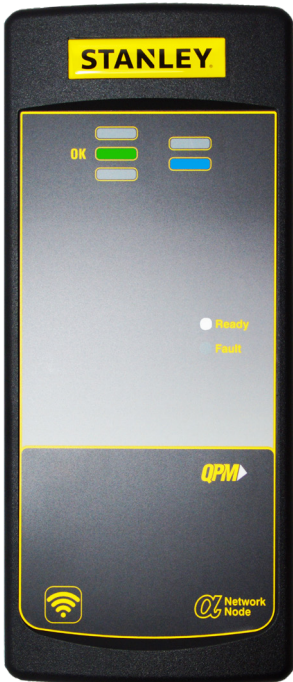

**QB0301 IEEE 802.15.4**  
*Manages 1 QPM  
 Cordless Tool*

## Benefits:

- » Simplified User Interface
- » Quick set-up with a PC, tablet, or smart phone
- » Alpha Toolbox, web-based software for set-up, programming, collecting data and performing diagnostics

## TECHNICAL FEATURES

- One Network Connection for Multiple Spindles
- One-to-One Wireless Connection
- Up to 6 QPM Cordless Tools
- IEEE 802.15.4, 2.4 GHz wireless option communication to Network Node (QB0301)
- Serial Port
- Embedded PLC
- 8 In/ 8 Out 24V I/O
- Embedded Modbus TCP
- Simple or Advanced Error Proofing

8 in/ 8 out 24 V  
 I/O for line control

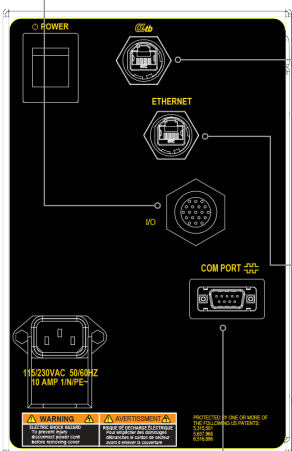

On board PLC

### Tool Configuration and Data Collection

- Alpha Toolbox functionality
- Browser based software delivered from Ethernet connection on controller

**Minimizes plant connections through a single point interface to the plant network**

**Serial port can connect to plant networks**



**Connect with Smart Phone**  
*(802.11 only)*

**24V I/O, WIFI and Modbus enables Socket Tray and alarms for Error Proofing. Socket Tray with integrated software for easy programming**



Error proofing I/O assures the job cannot inadvertently leave the station unless fastened as specified.



Socket Tray for error proofed fastening job selection enables a single tool to reliably assemble joints of different target torque levels

# How To Order Guide:

**B 2 3 L A 19 70**

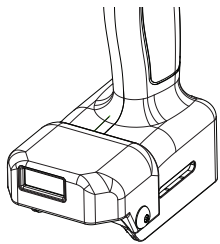
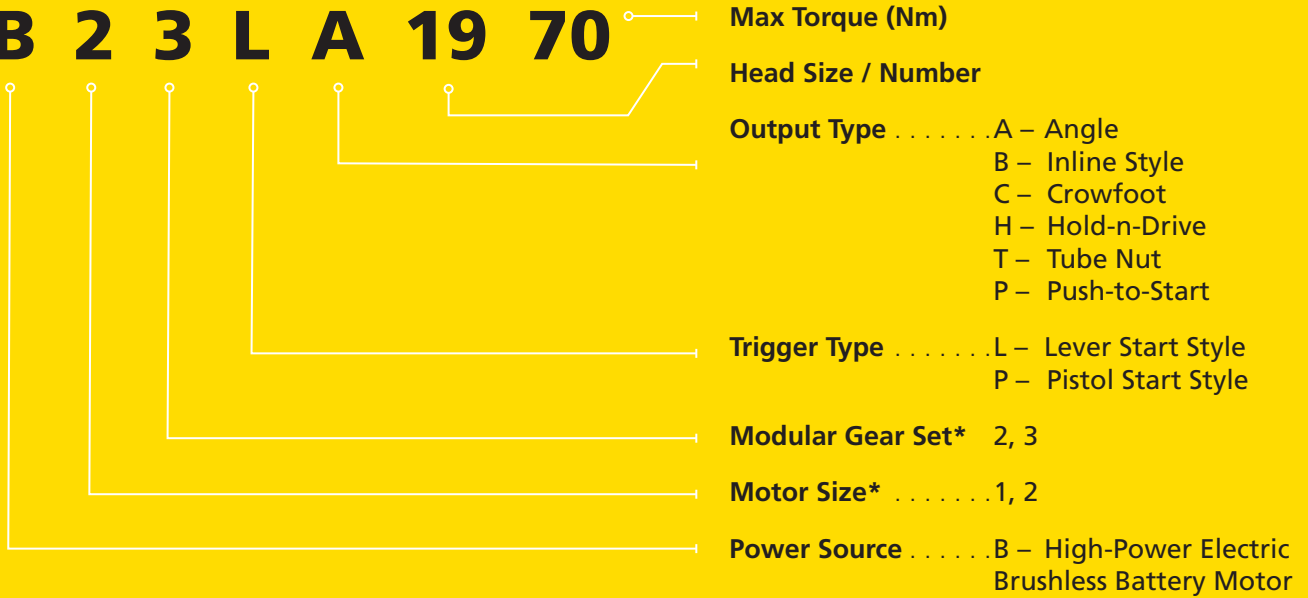

Barcode Scanner Option

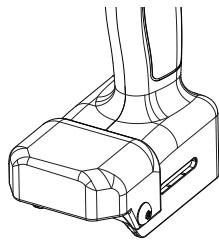

802.15.4 Radio Option



Programming Cable

## OPTIONS\*\*

Barcode Scanner		802.15.4 Radio	
<b>B12 Inline Pistol</b>	20H106100	<b>B12 Inline Pistol</b>	20H106102
<b>B12 PTS Pistol</b>	20H106101	<b>B12 PTS Pistol</b>	20H106103
<b>B12 Lever Tool</b>	20H106300	<b>B12 Lever Tool</b>	20H106301
<b>B23 Lever Tool</b>	20H106200	<b>B23 Lever Tool</b>	20H106202

## ACCESSORIES

**Programming Cable** | 20C206600

\*Pistol Start tools are only available in Motor Size 1 and Modular Gear Size 2.  
Lever Start tools are only available in Motor Size 2 and Modular Gear Size 3.

\*\*QPM Cordless tool can accommodate one option (e.g., a barcode scanner or an IEEE 802.15.4 radio).

**STANLEY**  
Engineered Fastening

StanleyEngineeredFastening.com

**WORLD HEADQUARTERS**  
STANLEY Engineered Fastening,  
Assembly Technologies

5335 Avion Park Drive  
Cleveland, Ohio 44143  
United States of America

Phone: 440.461.5500  
Sales: 877.709.8006  
Email: SATinfo@sbdinc.com

**STANLEY Engineered Fastening,**  
Assembly Technologies

Max-Eyth-Strasse 1  
35394 Giessen, Germany

Phone: +49 641 4050  
Email: SEF.Europe@sbdinc.com

